

REFURBISHED PORTABLE X-RAY SPECIFICATIONS

Amber Diagnostics has been refurbishing Portable X-Ray Systems Since 1994.

All systems can be custom refurbished to meet all of your specific financial budgets and technical requirements.

Amber Diagnostics refurbishes and re-assembles all GE AMX portables under a thorough electronic, mechanical and cosmetic refurbishing program. Upgrades may include critical structural reinforcements and replacement of major cabling and control components.

Amber Diagnostics then calibrates and tests each system to exacting OEM standards and are backed by a comprehensive warranty on workmanship and parts. Ask about our extensive inventory of new replacement battery systems and new, used and refurbished AMX parts.

AMBER
DIAGNOSTICS
Saving a Life Everyday



2180 Premier Row,
Orlando, FL 32809 USA

1-888-561-7900

407-438-7847

Fax: 407-856-5456

www.AmberUSA.com

GE AMX Portables AMX-IV



AMX IV

Our proprietary refurbishing and re-assembling processes includes complete system reconditioning, stage testing that assures the systems will pass original equipment manufacturers performance specifications and FDA laws. All systems sold are available with comprehensive warranty programs. Amber Diagnostics provides expert crating, shipping, installation, user and AIAT documentation, and system training to ensure that your equipment arrives in excellent working condition.

X-RAY SYSTEM FEATURES

Model	GE AMX-4
Ma	100
kVp	50-125
mAs	0.4-320
kVp Stations	24
mAs Stations	30
X-Ray Tube	MX-75 275k HU
Focal Spot	0.75 mm
Generator Frequency	High
Exposure Contact	Solid State

Dimensions: Height: 76", 1930 mm. Width: 25 3/16", 640 mm. Length: 45 3/8", 1153 mm. Weight: 1050 Lbs, 477 Kg.

Battery: Nine 12.9 volt batteries connected in series provide approximately 116 volt at full charge. Battery capacity is approximately 20,000 mAs at 100 kVp when fully charged and under specific operating conditions. Actual mAs capacity depends on the condition of the batteries, use of collimator lamp, electric brakes, rotor, and distance driven.

Movements: Tube vertical movement measured at the focal spot. Range: at least 52.5" (1334 mm). Lowest position: 26.1" (663 mm) maximum from floor. Highest position: 78.6" (1996 mm) minimum from floor. The horizontal movement measured at the focal spot relative to column face is 24" (610 mm) minimum, to 40" (1016 mm) maximum. Tube column rotation measured from horizontal latch is 360°. Tube and yoke rotation around Horizontal Arm measured from tube port down position: range: 360°; detent locations: 0, ±90°, and ±180°. Tube Trunion rotation measured from tube port down position: range: 120°, forward: 110°, backward: 10°, detent: 0°, and 90°. Collimator Rotation measured from the front of the collimator with the tube port facing down: range: 180°, right: 90°, left: 90°, detent: 0° and 90°

Drive Speed: There are two speeds: Drive Speed with the horizontal Arm secured for transport, and Maneuvering Speed with the horizontal Tube Arm removed from the Transport Latch. Drive speed is measured on a smooth, hard and level surface. Speed will be reduced by inclines, carpeted or soft surfaces. Drive speed is 264 feet (6705 mm) per minute ±25%. Maneuvering Speed is 30% to 60% of drive speed.

Reproducibility: The coefficient of variation of radiation output is less than 0.045 for successive exposures having constant technique factors.

Collimator: Minimum source to skin distance is limited to more than 30 cm by the skin spacers at the beam exit of the collimator. Full 17" x 17" (43 cm x 43 cm) radiographic coverage at 40" (1.02 m) source to image distance. Minimum inherent filtration of 2.0 mm aluminum equivalent at 100 kVp.

Light Filed Intensity: The average illumination at a distance of 100 cm (39.37") from the focal spot shall be 16 foot candles (170 lux) or more.

*Warranties are provided by Amber Diagnostics. Amber Diagnostics is not affiliated with GE Medical Systems, Inc.

REFURBISHED PORTABLE X-RAY SPECIFICATIONS

When considering the purchase or reallocation of an existing medical asset which is restored back to its original quality level and original manufacturers specifications can prove extremely cost effective.

For many organizations, purchasing refurbished equipment is a cost-effective alternative compared to purchasing new equipment. **Savings are typically 40 to 60 percent off less than new equipment.**

With this level of savings, healthcare organizations can stretch their equipment dollars, providing for multiple requirements.

Every refurbished system comes with a comprehensive warranty.

GE AMX Portables AMX-IV

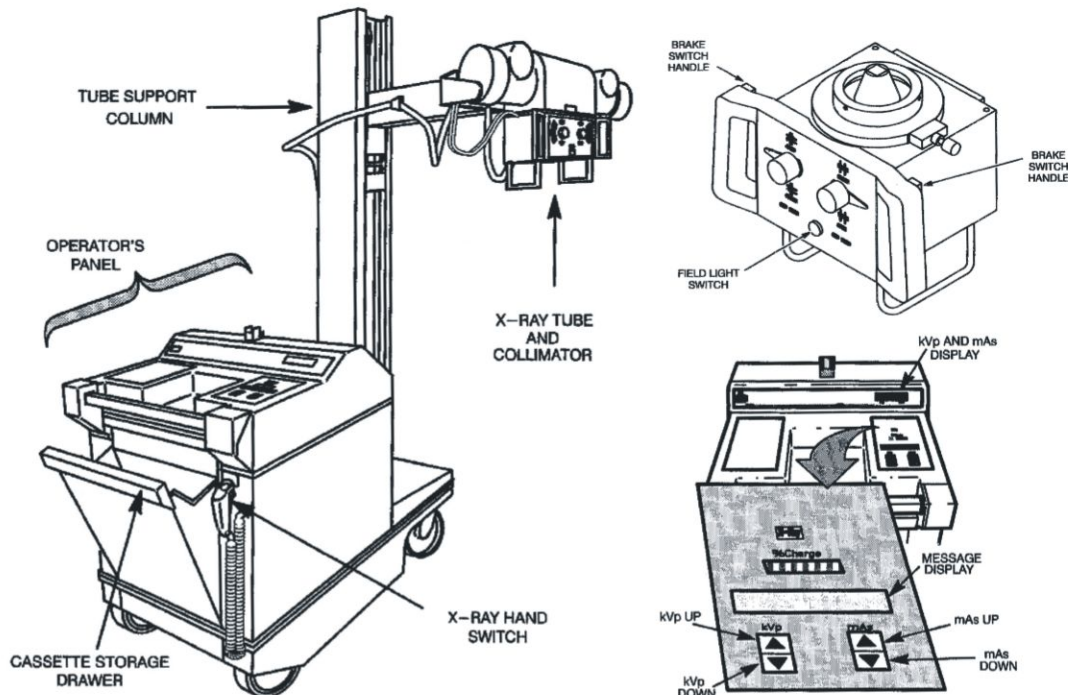

X-RAY SYSTEM FEATURES

Totally Mobile

- Operates bedside at full power with auxiliaries without a power connection.
- Variable speed, forward and reverse.

Versatile Power

- Constant-potential output makes 100 mA rating equivalent to 200 mA single phase conventional generators.
- Rechargeable battery pack has a capacity of 10,000 mAs measured @ 100 kVp; proportionally more mAs at lower kilo voltages.
- Silicon high-voltage rectifiers and solid state timer for consistent results.
- Solid state high frequency inverter.
- Overload protection for high-voltage components and battery pack.

Structurally Reinforced Column

- Column reinforcement upgrade kit installed on all pre-AMX-4 models.
 - New constant friction rotational lock.
 - Manual horizontal arm lock is replaced as necessary.
- Electric solenoid on AMX-4 column.
- All bearings are cleaned, inspected, repacked or replaced as necessary.

Structurally Reinforced Chassis

- Heavy-duty chassis upgrade includes several structural reinforcements.
- Front casters replaced (new style)
- New ABS plastic protective bumpers.

Cabling

- All high/ low voltage cables fully inspected.
- Remanufactured cord reel.

Remanufactured Drive System

- Differential axle, motor, drive chains, brakes, and gears are fully tested and repaired or replaced as necessary.

Tube/ Collimator Assembly

- Tube assembly is fully inspected.
- Tube yoke bushing, shaft fully inspected.
- Complete collimator inspection/ testing.
- Collimator windows and knobs fully inspected.

Reinforced Cassette Drawer

- Strengthened bottom plate assembly.
- Reinforced side panels and felt liner installed on AMX-110, II, and III's.
- Storage for ten 14" x 17" cassettes.

Hand switch Control

- Remote field light on hand switch.
- Retractable cord on AMX-110, II, III's fully inspected.

Maintenance-Free Battery Pack

- Sealed, Lead-Calcium upgrade.
- Eliminates need for periodic equalizing and potential overcharging.

REFURBISHING PROCESS



AESTHETICS



MECHANICAL
INTEGRITY



O.E.M. SYSTEM
REQUIREMENTS

AMBER DIAGNOSTICS

Saving a Life Everyday

2180 Premier Row,
Orlando, FL 32809 USA

1-888-561-7900

407-438-7847

Fax: 407-856-5456

www.AmberUSA.com